



WW180X

Single Belgian Waffle Maker



Single Belgian Waffle Maker

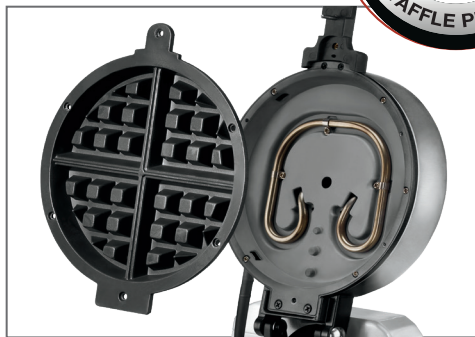

MAIN FEATURES

- Produces up to 25 Belgian waffles (1" thick) per hour
- Heavy-duty, commercial construction for durability
- Rotary feature for even baking and browning
- Triple-coated nonstick plates allow for easy removal of waffles and quick cleanup
- Plates are user serviceable for easy onsite replacement if scratched
- Power ON and READY-TO-BAKE LED indicators, plus audio chime signals when the unit is ready to cook and when the waffle is ready to serve
- Removable, dishwasher-safe drip tray makes cleanup quick and easy
- Limited One Year Warranty on machine, 90-day warranty on plates

ELECTRICAL

Voltage: 120

Frequency: 60Hz

Watts: 1200

Amps: 10

Plug Type: NEMA 5-15P ⓘ

Cord Length: 3 feet



SALES FEATURES

Elevate your menu by taking waffles beyond breakfast and into sweet and savory dishes. Designed with a rotary feature to ensure even results, the Waring® WW180X Single Belgian Waffle Maker bakes up to 25 Belgian waffles per hour. Triple-coated nonstick plates easily release flawlessly formed Belgian waffles—and because the plates are user serviceable, they are simple to replace if scratched.



@waringcommercial

©2019 Waring Commercial
314 Ella T. Grasso Avenue, Torrington, CT 06790
Tel. 800-492-7464 • Fax 860-496-9008

waringcommercialproducts.com

WW180X



DIMENSIONS

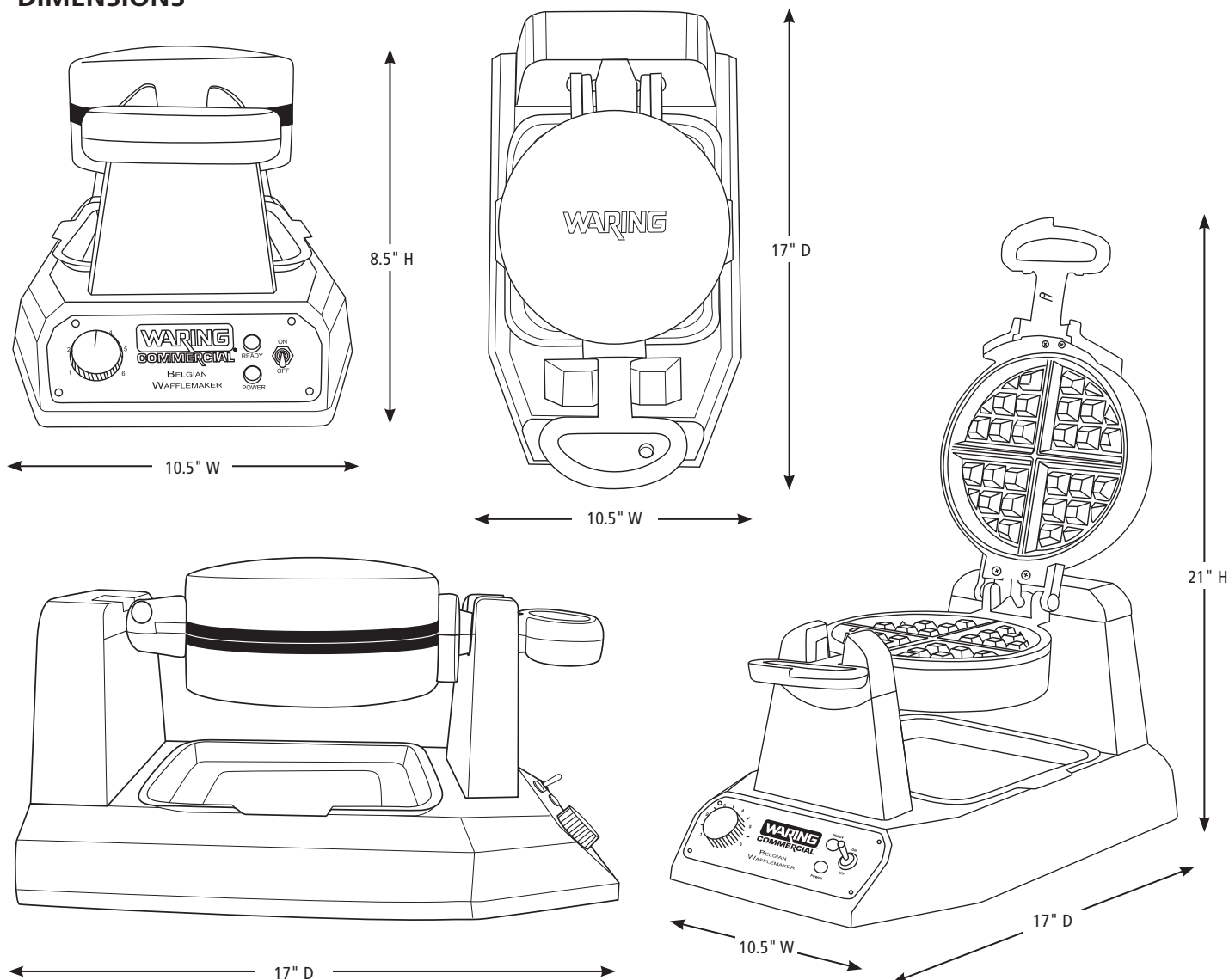

Out of Box Weight: 13.3 lb.

| ORDERING INFORMATION | #STD. PKG. | GIFTBOX WEIGHT | CUBIC FEET | BOX DIMENSIONS D X W X H | UPC | CASE PKG. | MC WEIGHT | MC DIMENSIONS D X W X H | MBC |
|---|------------|----------------|------------|--------------------------|--------------|-----------|-----------|--------------------------|----------------|
| WW180X – Single Belgian Waffle Maker | 1 | 14.3 | 1.358 | 12.5" x 17.875" x 10.5" | 040072086564 | 1 | 14.3 | 13.25" x 18.25" x 11.25" | 10040072086561 |
| WW180XRP – Belgian Waffle Plate Replacement Kit | 1 | 2.25 | 0.081 | 8" x 1.875" x 9.375" | 040072088100 | 16 | 37.625 | 16.125" x 10" x 15.625" | 10040072088107 |



@waringcommercial

©2019 Waring Commercial
 314 Ella T. Grasso Avenue, Torrington, CT 06790
 Tel. 800-492-7464 • Fax 860-496-9008

waringcommercialproducts.com

19WC063589 / REV 12/19