

ASSEMBLY INSTRUCTIONS

Industrial Pipe and Wood Shelving

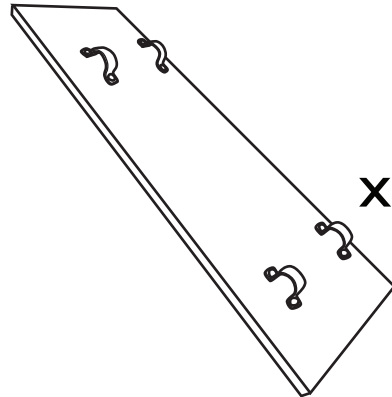

PARTS INCLUDED



x 1

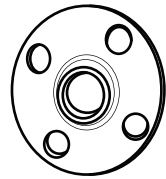

x 2

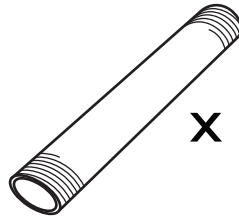

x 2

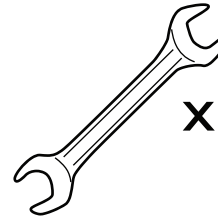

x 1

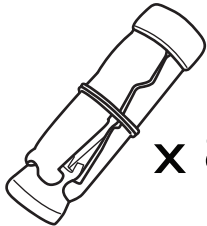

x 8

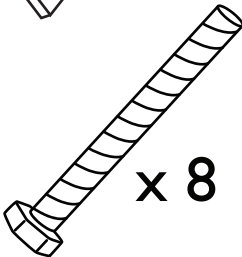

x 8

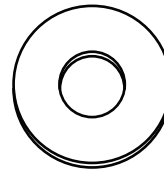

x 8

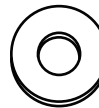

x 8



x 2

YOU WILL NEED: (NOT INCLUDED)

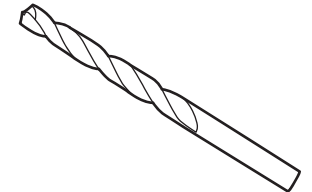
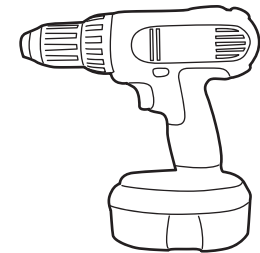
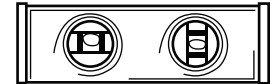
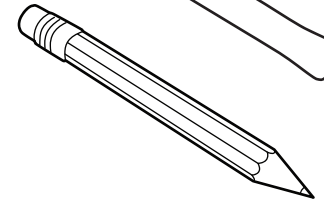
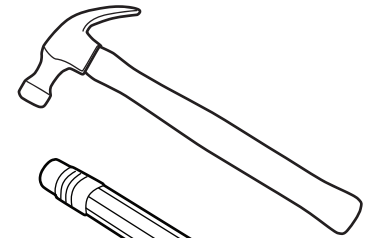

6MM DRILL BIT

ASSEMBLY INSTRUCTIONS

Industrial Pipe and Wood Shelving

- 1 SCREW PIPES TO ROUND METAL PLATES

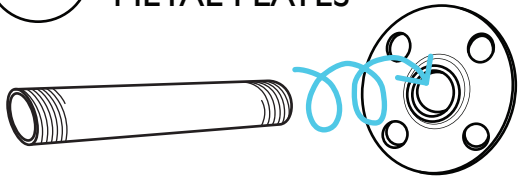

- 2 INSERT PIPES THROUGH ROUND BRACKETS ON SHELF AND USE LEVEL TO POSITION THE SHELF ON THE WALL.

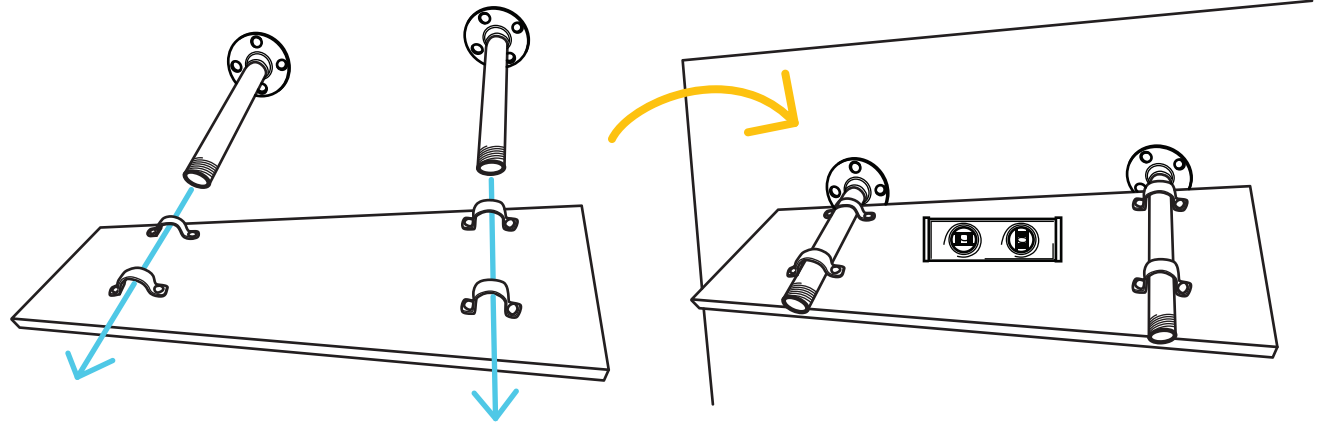

- 3 USE PENCIL TO MARK WALL INSIDE TOP THREE HOLES ON RIGHT PLATE.

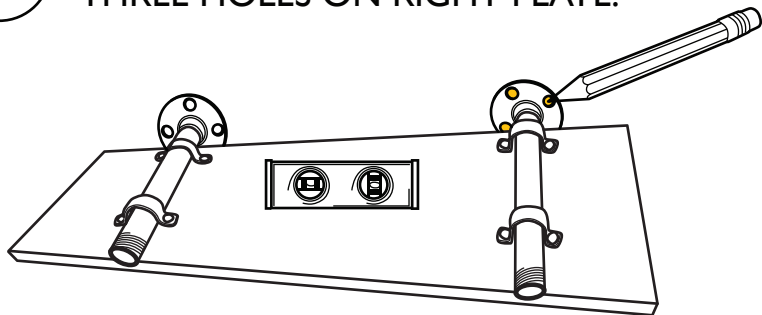

- 4 SET SHELF ASIDE AND USE ONE OF THE ROUND PLATES AS A GUIDE TO MARK THE FOURTH HOLE.

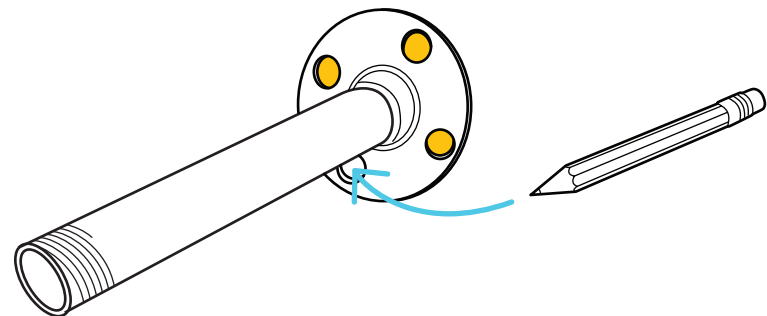

ASSEMBLY INSTRUCTIONS

Industrial Pipe and Wood Shelving

- 5 DRILL HOLES IN WALL AT PENCIL MARKS AND INSERT WALL ANCHORS AS SHOWN. TAP WITH HAMMER UNTIL THEY ARE EVEN WITH SURFACE.

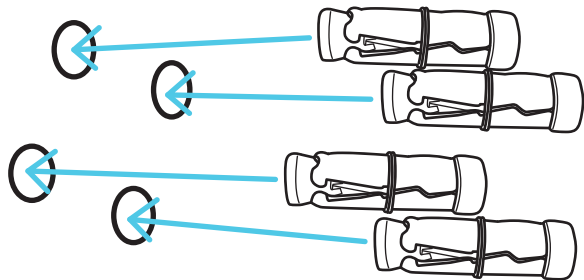

- 6 ALIGN HOLES WITH WALL ANCHORS AND TIGHTEN FOUR BOLTS, SMALL WASHERS AND LARGE WASHERS IN THE ORDER SHOWN.

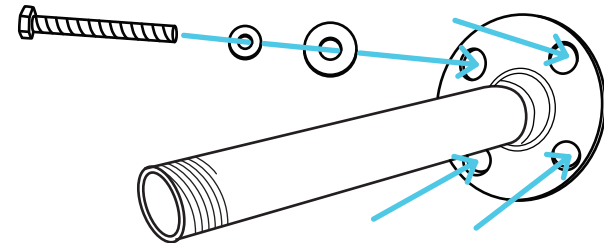

- 7 SLIDE SHELF AND REMAINING PIPE ONTO MOUNTED PIPE WITH ROUND BRACKETS ON BOTTOM. USE LEVEL TO ALIGN THE SHELF AND MARK WALL IN BOTTOM THREE HOLES OF LEFT ROUND METAL PLATE. REPEAT STEPS 4-6 TO ATTACH SECOND PIPE TO WALL.

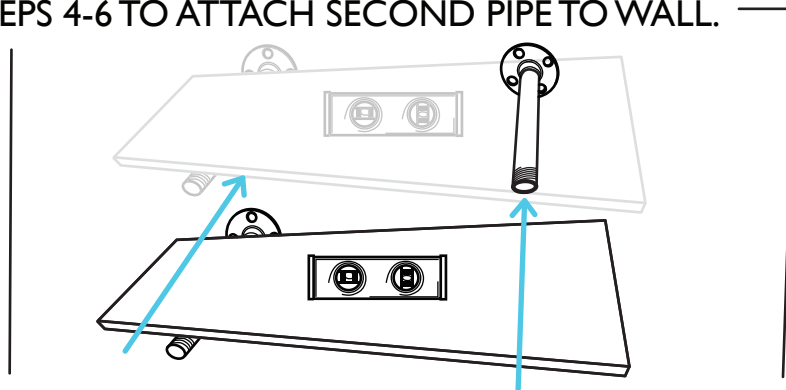

- 8 SLIDE SHELF ONTO PIPES AND SCREW ON ELBOW NUTS TO FINISH.

