

ASSEMBLY INSTRUCTIONS

designed and manufactured by **MOBILE MERCHANDISERS**

FLORAL DISPLAY CART Model #FC2452 – ASSEMBLY DIAGRAM

PARTS LIST:

- 1 – Base
- 1 – Left-side leg
- 1 – Right-side leg
- 2 – Leg braces
- 1 – Header
- 1 – Sign frame
- 4 – Vase holder brackets
- 1 – Bag hook
- 2 – Rearwheels

HARDWARE:

- 6 – 3/8" bolts(for frame)
- 6 – 3/8" flat washers(for frame)
- 6 – 3/8" lock washers(for frame)
- 2 – 3/8" floor glides
- 2 – 3/8" lock washers (for floor glides)
- 2 – Acorn nuts (for wheels)
- 4 – 1/2" flat washers (for wheels)
- 2 – 1/2" lock washers (for wheels)
- 2 – Phillips bolts (for header)
- 2 – Phillips screws (for sign frame)
- 2 – 1/4" Hex bolts (for bag hook)
- 2 – Allen wrenches
- 1 – Crescent wrench
- 1 – Phillips screwdriver

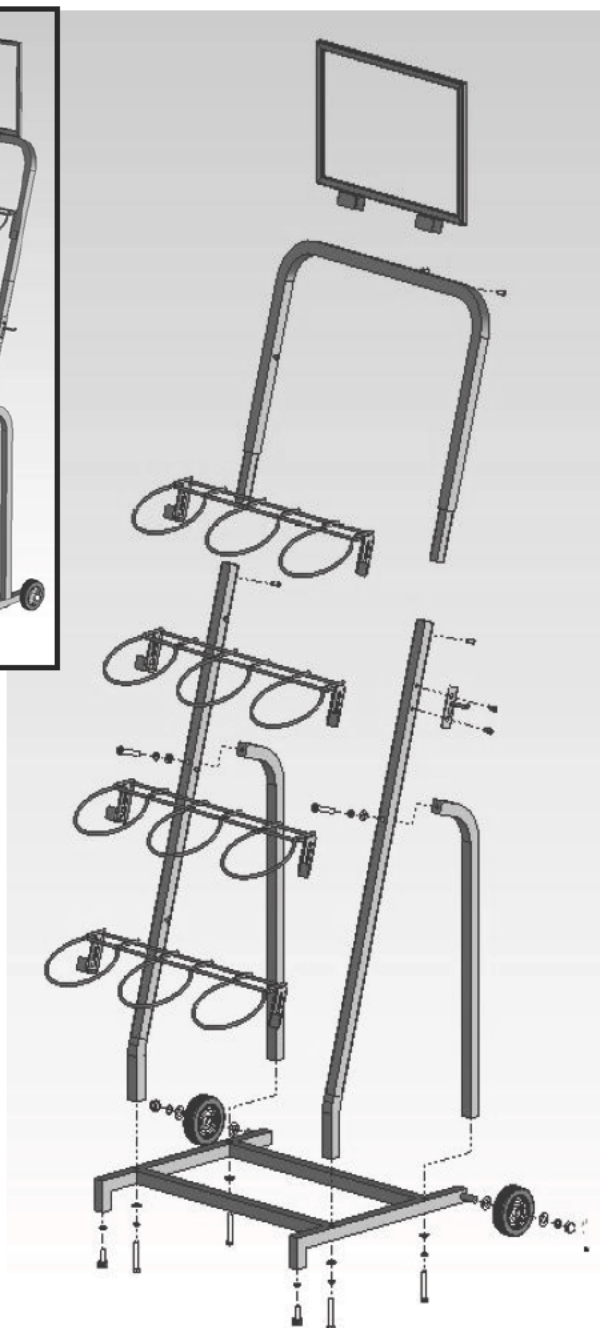
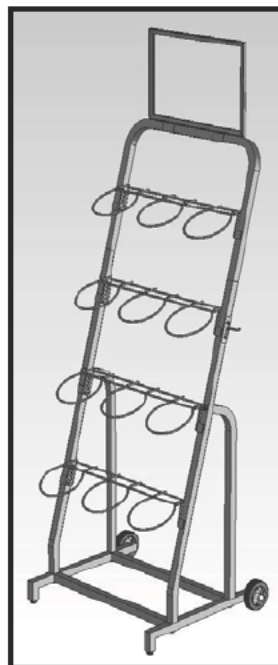

HELPFUL HINTS:

- Make sure "mushroom heads" in legs face to inside (for vase holder brackets).
- The bag hook can be mounted to either side of the display.



2611 Henson Rd.

P.O. Box 1223

Mount Vernon, WA 98273

(800)452-9809

Email: sales@mobmerch.com

www.mobmerch.com