



Outperform every day.™

Care and Use

Cubic Beverage Dispenser

Item Number(s): V904800

FUNCTION AND PURPOSE

This equipment is designed to help keep beverages chilled at proper serving temperature.

BEFORE FIRST USE

Wash and thoroughly dry all components. See Cleaning.

OPERATION

1. Pre-chill the beverage product.
2. Fill the ice tube with ice and insert into the beverage body.
3. Place the pre-chilled beverage product into the beverage body.
4. Regularly check the beverage temperature.

NOTICE: Monitor food temperature closely for food safety. The United States Public Health Service recommends that cold food/beverage be held at a maximum of 41 °F (5 °C) to help prevent bacteria growth.

5. As needed, remove the drip tray to clean any spilled beverage.
6. When finished using the dispenser, remove and empty the beverage body and ice tube.



CLEANING

To maintain the appearance and increase the service life, clean your equipment daily.

NOTICE: Components are not dishwasher safe.

NOTICE: Do not use ammonia based cleaners on acrylic or plastics.

NOTICE: Do not use abrasive materials, scratching cleansers or scouring pads. These can damage the finish.

1. Disassemble the dispenser.
2. Follow the instructions below for cleaning the components.

Painted Wood Tower and Drip Tray Holder

1. Wipe the painted wood tower and drip tray holder with a damp soft cloth.
NOTICE: Do not submerge or soak in liquid.
2. Dry the components thoroughly.

Beverage Body Components and Drip Tray

1. Thoroughly hand wash the beverage body, cover, ice tube and drip tray with hot water and mild soap.
2. Rinse the components with warm water.
3. Dry the components thoroughly.

Faucet

1. Unscrew the faucet assembly from the beverage body.
2. Disassemble the faucet.

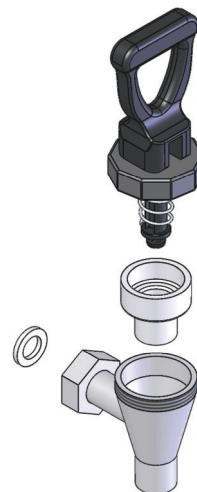

3. Hand wash and sanitize the components.
4. Reassemble and reinstall the faucet into the beverage body.