

READY TO ASSEMBLE

# Lectern Base • Tabletop • Combo MODEL #22 • 112 • 22/112

[CLICK HERE TO VIEW MARKETING VIDEO](#)

**Lectern Combo**  
Model #22/112

non sound

THE OS® UNPRECEDENTED WARRANTY ON ALL PRODUCTS  
**10** YEARS

## FEATURES

### Tabletop Lectern (Model #22)

- Tabletop lectern functions great on its own or in conjunction with the #112 floor lectern base (sold separately)
- Features a convenient paper/book stop
- Large ample reading surface
- High pressure thermal-fused laminate on a PB core
- Durable scratch resistant surface
- Ships Ready to Assemble, UPS

### Lectern Base (Model #112)

- The #112 is an attractive and durable AV cart ideal for supporting presentation equipment
- This unit conveniently serves as a base for the OS Model #22 tabletop lectern to create a beautiful mobile full floor lectern
- Sturdy cabinetry includes a shelf with ample storage space  
Shelf measures 19.5"W x 14.5"H
- Four easy-roll casters included, two locking
- High pressure thermal-fused laminate on a PB core
- Durable scratch resistant surface
- Ships Ready to Assemble, UPS



### COLOR OPTIONS

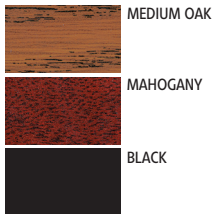

### AVAILABLE ACCESSORIES



**#2CS**  
CASTER KIT  
COMES STANDARD WITH MODEL #112



### 22

#### TECHNICAL SPECIFICATIONS

OVERALL DIMENSIONS **13.75"H x 23.75"W x 19.875"D**  
WEIGHT **31 lbs.**

### 112

#### TECHNICAL SPECIFICATIONS

OVERALL DIMENSIONS **33.75"H x 21.125"W x 17.5"D**  
SHELF DIMENSIONS **19.5"W x 14.5"H**  
WEIGHT **50 lbs.**

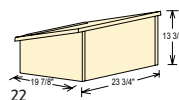
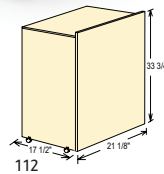

**Oklahoma Sound**

800.261.4112 | www.oklahomasound.com