



# GRINDMASTER™

C O R P O R A T I O N

Item # \_\_\_\_\_

Project \_\_\_\_\_

Date \_\_\_\_\_

## Airpot Racks

### For 2.2L Push Top and Lever Top Airpots

- Keeps beverage stations neat, clean, and organized
- Saves valuable counter space
- Modular components can be combined to create various styles
- Signage merchandises your product for increased sales
- Attractive, durable, black powder-coated finish
- Sturdy steel construction
- Condiment holder available
- Removable drip pans

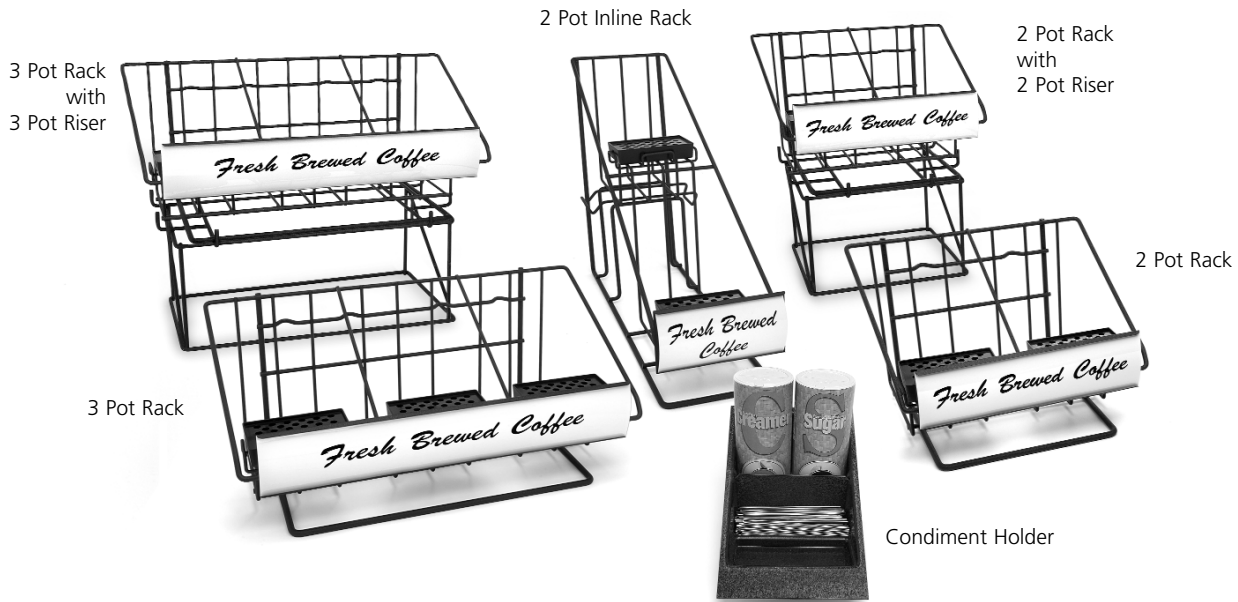

# Airpot Racks

## For 2.2L Push Top and Lever Top Airpots

**2 Pot Inline Rack**  
(Part # 70620)

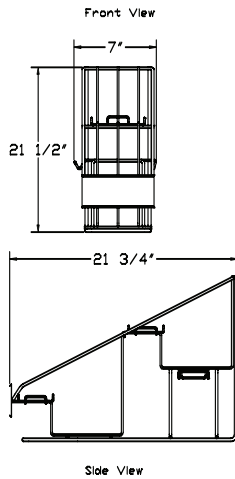

**2 Pot Wide Rack**  
(Part # 70577)

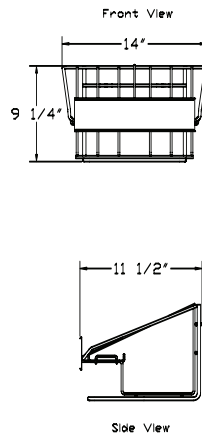

**3 Pot Wide Rack**  
(Part # 70571)

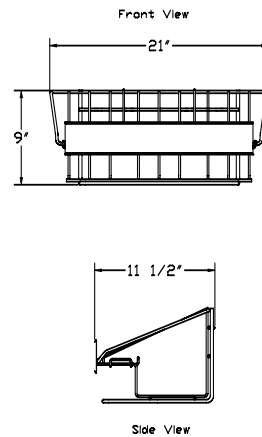

	<b>2 Pot Inline Rack</b>	<b>2 Pot Wide Rack</b>	<b>3 Pot Wide Rack</b>
Rack only	part # 70620	part # 70577	part # 70571
Rack with pots	part # 70759	part # 70659	part # 70651
Dimensions (H x W x D)	21-1/2" x 7" x 21-3/4" (55cm x 18cm x 55cm)	9-1/4" x 14" x 11-1/2" (23cm x 36cm x 29cm)	9" x 21" x 11-1/2" (23cm x 53cm x 29cm)
Material	Black powder coated steel	Black powder coated steel	Black powder coated steel
Diameter of opening for airpot	6-1/2" (17cm) <i>Fits most 1.9L-2.2L airpots</i>	6-1/2" (17cm) <i>Fits most 1.9L-2.2L airpots</i>	6-1/2" (17cm) <i>Fits most 1.9L-2.2L airpots</i>
Ship Dimensions (H x W x D)	Rack only: 16-1/2" x 8" x 22-1/2" (42cm x 20cm x 57cm) Rack with pots: 18-1/4" x 8-1/2" x 36-1/2" (46cm x 22cm x 93cm) <i>Rack with pots ship in one box</i>	Rack only: 9" x 13-1/2" x 11-1/2" (23cm x 34cm x 29cm) Rack with pots: 24-1/2" x 12-1/2" x 18-3/4" (62cm x 32cm x 48cm) <i>Rack with pots ship in one box</i>	Rack only: 9" x 20-1/2" x 11-3/4" (23cm x 52cm x 30cm) Rack with pots: 29-1/2" x 12-1/2" x 27" (46cm x 22cm x 93cm) <i>Rack with pots ship in one box</i>
Ship Weight	Rack only: 7 lbs (3 kg) Rack with pots: 21 lbs (9.5 kg)	Rack only: 6 lbs (2.7 kg) Rack with pots: 16 lbs (7.3 kg)	Rack only: 8 lbs (4 kg) Rack with pots: 27 lbs (12.3 kg)

Specifications are subject to improvement or change without notice.



Tel (502) 425-4776 • Fax (502) 425-4664 • 1-800-695-4500 (USA & Canada only)  
P.O. Box 35020 • Louisville, KY 40232 • USA  
www.grindmaster.com • email: info@grindmaster.com